

RAS 5000

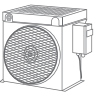

PURCHASE CODES

| | |
|--------------------------------|-------------------|
| RAS 5000 without thermo-switch | 3RRAS5000 |
| RAS 5000 with thermo-switch | 3RRAS5000T |

SPARE PARTS

| | |
|----------------------------------|---------------|
| Electronic thermo-switch | 1TRM RAS |
| 2m thermo-switch probe | 1SND RAS |
| 4m thermo-switch probe | 1SND ROC4M |
| Oil filter | 1FTR MPS50 |
| Electric junction box | 1CSSDSAR336 |
| Cooling element | 1RONO3 |
| Cooling element protection grill | 3TLPRAS5000.1 |
| Housing | 3TLRAS5000.1 |
| Fan | 1GRAS5000 |
| Fan grill | 3RTRAS5000.1 |
| Pump | 1PORAS5000 |
| Electric motor | 1MRAS5000 |

DIMENSIONS

| A | B | C | D | E | F | G |
|-----|-----|-----|-----|-----|-----|-----|
| 450 | 405 | 203 | 470 | 250 | 500 | 200 |

- Dimensions and technical characteristics are not binding

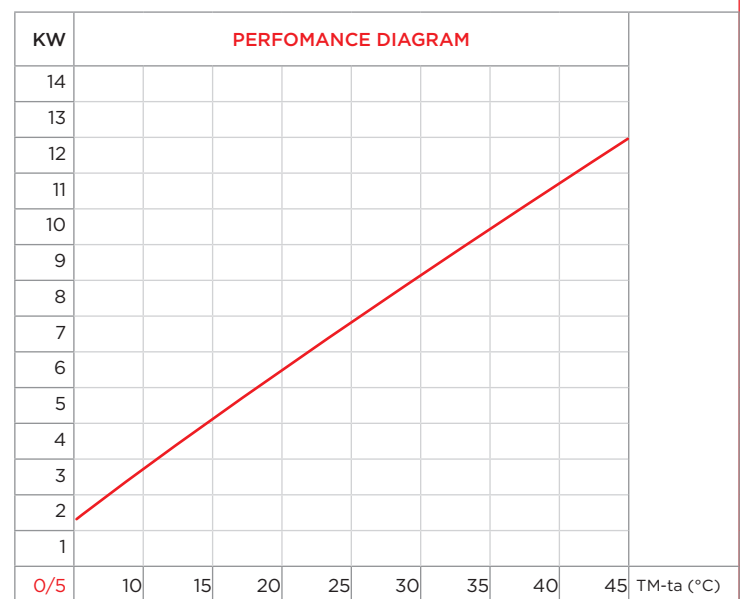
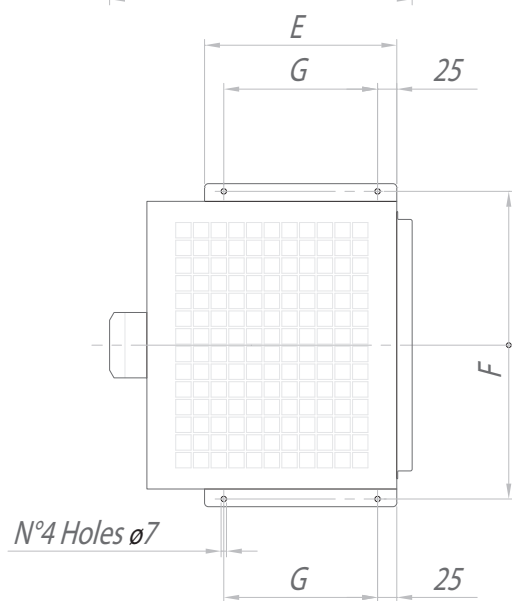
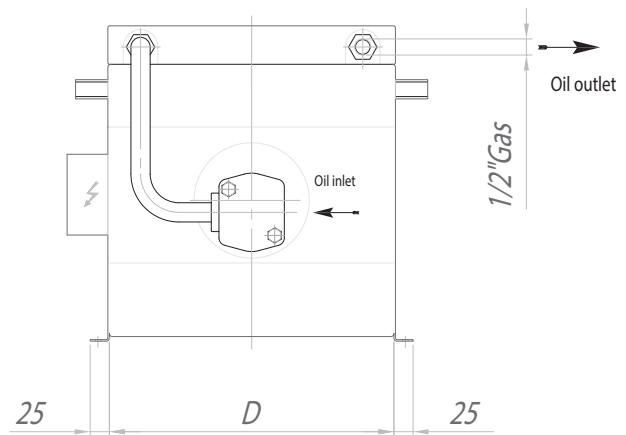
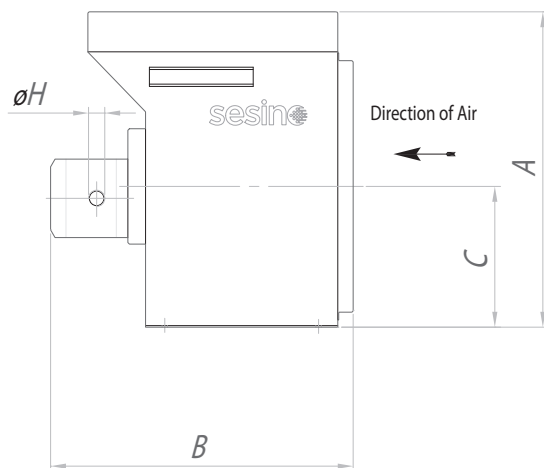

| OIL FLOW | VOLTAGE | | HZ | POWER | CURRENT | ELECTRICAL PROTECTION | AIR FLOW | NOISE LEVEL | WEIGHT |
|----------|---------|---------|----|-------|---------|-----------------------|----------|-------------|--------|
| l/min | Δ | Y | | W | A | IP | m³/h | dB(A) | kg |
| 22 | 230-240 | 380-420 | 50 | 750 | 3,5-2,0 | 55 | 1.500 | 70 | 36 |
| 22 | 254-280 | 440-480 | 60 | 750 | 3,5-2,0 | 55 | 1.500 | 70 | 36 |