

R551

Description

Brass distribution manifolds, with female threaded connections and outputs.

Technical data

- Temperature range: 5÷110 °C
- Max. working pressure: 16 bar
- Main connections and output female threaded ISO228.

Materials

- CW605N brass

Versions and product codes

| Product code | Manifold connections x outputs | N° of outputs |
|--------------|---|---|
| R551Y002 | 3/4"F x 3/8"F (ISO 228) Centre distance 35 mm | 2 |
| R551Y003 | | 3 |
| R551Y004 | | 4 |
| R551Y005 | | 5 |
| R551Y006 | | 6 |
| R551Y007 | | 7 |
| R551Y008 | | 8 |
| R551Y009 | | 9 |
| R551Y010 | | 10 |
| R551Y011 | | 11 |
| R551Y012 | | 12 |
| R551Y022 | | 3/4"F x 1/2"F (ISO 228) Centre distance 50 mm |
| R551Y023 | 3 | |
| R551Y024 | 4 | |
| R551Y025 | 5 | |
| R551Y026 | 6 | |
| R551Y027 | 7 | |
| R551Y028 | 8 | |
| R551Y029 | 9 | |
| R551Y030 | 10 | |
| R551Y031 | 11 | |
| R551Y032 | 12 | |
| R551Y042 | 1"F x 3/8"F (ISO 228) Centre distance 35 mm | 2 |
| R551Y043 | | 3 |
| R551Y044 | | 4 |
| R551Y045 | | 5 |
| R551Y046 | | 6 |
| R551Y047 | | 7 |
| R551Y048 | | 8 |
| R551Y049 | | 9 |
| R551Y050 | | 10 |
| R551Y051 | | 11 |
| R551Y052 | | 12 |
| R551Y062 | 1"F x 1/2"F (ISO 228) Centre distance 50 mm | 2 |
| R551Y063 | | 3 |
| R551Y064 | | 4 |
| R551Y065 | | 5 |
| R551Y066 | | 6 |
| R551Y067 | | 7 |
| R551Y068 | | 8 |
| R551Y069 | | 9 |
| R551Y070 | | 10 |
| R551Y071 | | 11 |
| R551Y072 | | 12 |

| Product code | Manifold connections x outputs | N° of outputs |
|--------------|---|---|
| R551Y082 | 1 1/4"F x 1/2"F (ISO 228) Centre distance 50 mm | 2 |
| R551Y083 | | 3 |
| R551Y084 | | 4 |
| R551Y085 | | 5 |
| R551Y086 | | 6 |
| R551Y087 | | 7 |
| R551Y088 | | 8 |
| R551Y089 | | 9 |
| R551Y090 | | 10 |
| R551Y091 | | 11 |
| R551Y092 | | 12 |
| R551Y102 | | 1 1/4"F x 3/4"F (ISO 228) Centre distance 70 mm |
| R551Y103 | 3 | |
| R551Y104 | 4 | |
| R551Y105 | 5 | |
| R551Y106 | 6 | |
| R551Y182 | 1 1/2"F x 1"F (ISO 228) Centre distance 100 mm | |
| R551Y183 | | 3 |
| R551Y184 | | 4 |
| R551Y185 | | 5 |
| R551Y186 | | 6 |
| R551Y187 | | 7 |
| R551Y188 | | 8 |
| R551Y189 | | 9 |
| R551Y190 | | 10 |
| R551Y191 | | 11 |
| R551Y192 | | 12 |
| R551Y162 | 2"F x 1"F (ISO 228) Centre distance 100 mm | 2 |
| R551Y163 | | 3 |
| R551Y164 | | 4 |
| R551Y165 | | 5 |
| R551Y166 | | 6 |

Optional

- Insulation, R551W series
- Fittings and/or ball valves with ISO 228 male threads can be installed on the manifold's outputs.



Installation

R551 manifolds of 3/4", 1" and 1 1/4" size can be mounted into the R500 cabinets with the R588 brackets or into the R500-2 cabinets with the R588Z brackets.

R551 manifolds of 1 1/2" and 2" size can be mounted on the wall with the R588P brackets.

To intercept the flow and facilitate eventual maintenance works, at the beginning of the manifold is possible to install interception ball valves with male threads or intermediate fittings for manifolds (i.e. R554D, R269T...).

At the end of the manifold is possible to install the terminal groups (i.e. R554B, R554L...) or terminal plugs for manifolds (i.e. R592D).

Product specifications

R551

Brass distribution manifold, with ISO 228 male threaded connections and outputs. Temperature range 5÷110 °C. Max. working pressure 16 bar.

Dimensions

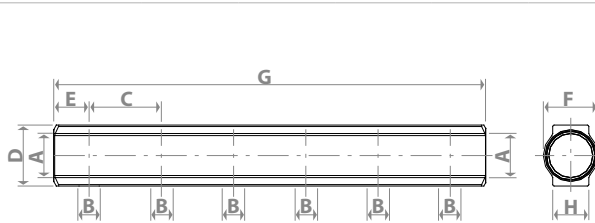

| A x B | C [mm] | D [mm] | E [mm] | F [mm] | H [mm] |
|-----------------|--------|--------|--------|--------|--------|
| 3/4"F x 3/8"F | 35 | 35 | 21 | 31 | 20 |
| 3/4"F x 1/2"F | 50 | 36 | 23 | 31 | 25 |
| 1"F x 3/8"F | 35 | 41 | 23 | 38 | 20 |
| 1"F x 1/2"F | 50 | 42 | 25 | 38 | 25 |
| 1 1/4"F x 1/2"F | 50 | 51 | 25 | 47 | 25 |
| 1 1/4"F x 3/4"F | 70 | 51 | 27 | 47 | 31 |
| 1 1/2"F x 1"F | 100 | 62 | 35 | 55 | 38,5 |
| 2"F x 1"F | 100 | 74 | 37 | 68 | 38,5 |

| N° of outputs | G [mm] | | | | | | | |
|---------------|---------------|---------------|-------------|-------------|-----------------|-----------------|-------------|-----------|
| | 3/4"F x 3/8"F | 3/4"F x 1/2"F | 1"F x 3/8"F | 1"F x 1/2"F | 1 1/4"F x 1/2"F | 1 1/4"F x 3/4"F | 1 1/2"x 1"F | 2"F x 1"F |
| 2 | 76 | 95 | 80 | 99 | 99 | 124 | 169 | 174 |
| 3 | 111 | 145 | 115 | 149 | 149 | 194 | 269 | 274 |
| 4 | 146 | 195 | 150 | 199 | 199 | 264 | 369 | 374 |
| 5 | 181 | 245 | 185 | 249 | 249 | 334 | 469 | 474 |
| 6 | 216 | 295 | 220 | 299 | 299 | 404 | 569 | 574 |
| 7 | 251 | 345 | 255 | 349 | 349 | - | 669 | - |
| 8 | 286 | 395 | 290 | 399 | 399 | - | 769 | - |
| 9 | 321 | 445 | 325 | 449 | 449 | - | 869 | - |
| 10 | 360 | 495 | 360 | 499 | 499 | - | 969 | - |
| 11 | 391 | 545 | 395 | 549 | 549 | - | 1069 | - |
| 12 | 426 | 595 | 430 | 599 | 599 | - | 1169 | - |

Additional information

For more information, go to www.giacomini.com or contact our technical assistance service: ☎ +39 0322 923372 📠 +39 0322 923255 ✉ consulenza.prodotto@giacomini.com

This document provides only general indications. Giacomini S.p.A. may change at any time, without notice and for technical or commercial reasons, the items included herewith.

The information included in this technical sheet do not exempt the user from strictly complying with the rules and good practice standards in force.

Giacomini S.p.A. Via per Alzo, 39 - 28017 San Maurizio d'Opaglio (NO) Italy