

Shaft:	Aluminum
Bearings:	2 x 6805 ZZ C2
Torque:	0.4 oz/in (3 N-cm)
Humidity:	Up to 98% permissible
Speed:	3000 RPM max.
Shock:	10g (6msec)
Vibration:	5g (500 Hz)
Shaft load:	Radial/Axial max 10 lbs
Line driver output max:	50 mA per channel
Max. ppr	2048

Output

A is 90 degrees before B in clockwise direction

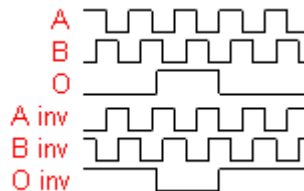

Inertia: 30gm-cm²

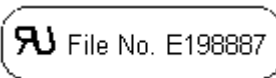

Mounting Instructions

Mount fixture to the encoder with three self-tapping no. 8 screws and three no. 8 washers. Slide the encoder onto the shaft. With the setscrew, tighten the hollow shaft onto the shaft. Mount the tether on the machine or motor-frame. The tether can be bent to adapt to any surface. This assembly allows the encoder to float and increases the lifetime of the bearings. Connect the encoder as per wiring specifications. Make sure power supply is within the proper voltage and current rating. Encoder can be mounted with the setscrew on the machine side or on the opposite side for either CW or CCW. See datasheet for CW and CCW directions of the outputs.

Technical data for tether: 0.3 mm stainless steel sheet

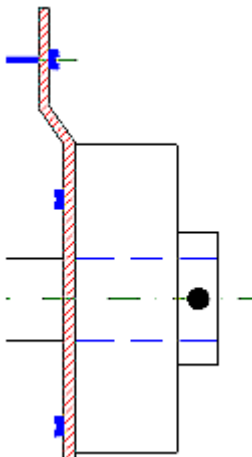

Dimensions

