



GRUPPO

DIRECT OPERATED SOLENOID VALVES

SCHEDA  
TECNICA

DENOMINAZIONE

SOL. VALVE 10mm 3/2 NC (MULT. ELECTR. CONN.)

CODICE

N371.R16

NUMERO

076/300

I.M.

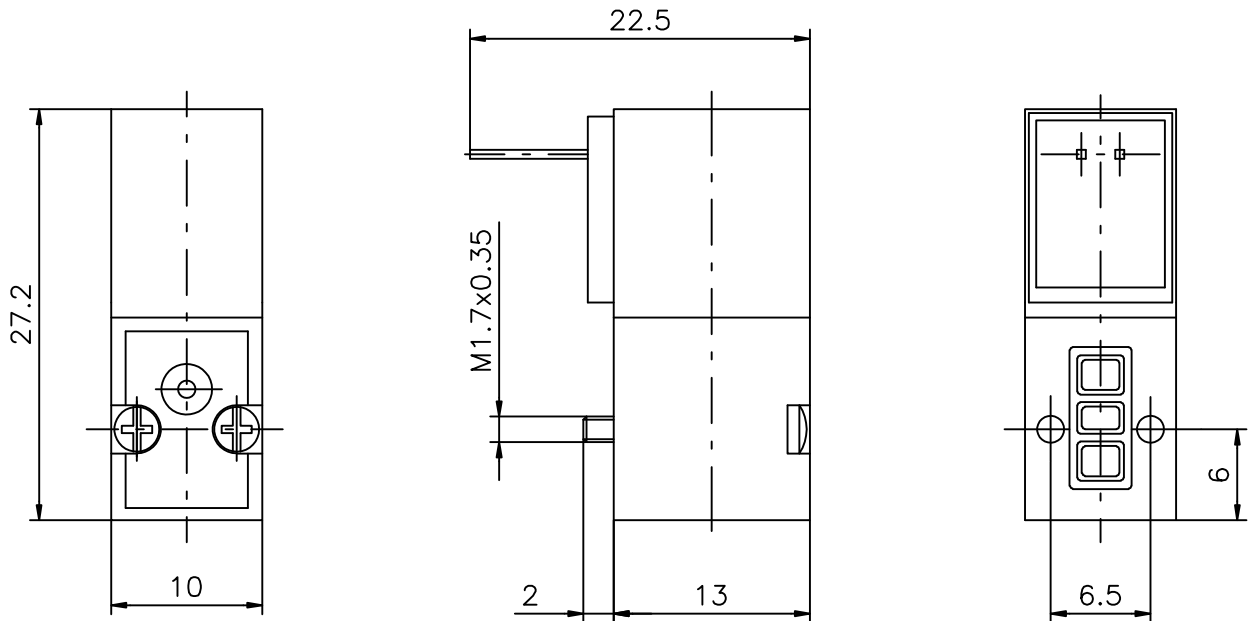

TECHNICAL CHARACTERISTICS

Working pressure :	0-7 bar / 0-100 psi
Ambient temperature range :	-5°+50°C
Flow rate at 6 Bar with $\Delta p=1$ (from 1 to 2)	14 NI/min.
Cv factor :	0.014
Flow rate at 6 Bar with $\Delta p=1$ (from 2 to 3)	20 NI/min.
Switching time :	10/12 ms
Voltage tolerance :	-5%+10%
Nominal orifice size :	0.7 mm
Power :	1.3 Watt
Fixing screws :	M1,7x0.35
Suggested torque force for fixing screws :	0.25 Nm

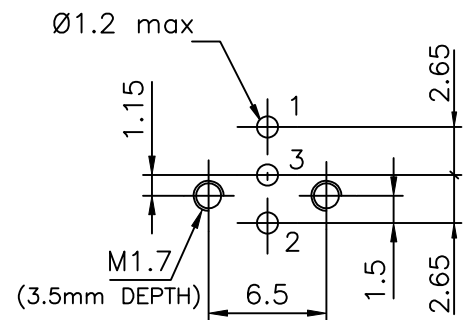

INTERFACE DIMENSION

						COMPILATO	CONTROLLATO	
						DATA	04/08/2000	17/07/2000
						FIRMA	A.Maffi	S.Locatelli
						QUESTO ELABORATO E' DI PROPRIETA' RISERVATA DI PNEUMAX S.p.A.-LURANO (BG) E' VIETATA LA RIPRODUZIONE SENZA AUTORIZZAZIONE		
I.M.	DESCRIZIONE MODIFICA	FIRMA	DATA	CONTROLL.	DATA			