

Micro Limit Switch Series 8064

- Explosion protection to
 - CENELEC
 - IEC
- Can be used in Zone 1 und Zone 2
- Devices can be supplied as
 - Built-in micro limit switches with single core connections
 - Micro limit switches with flexible lead
- Version as limit switch with
 - Snap-action contact
Contact separation:
 $2 \times \geq 0,3 \text{ mm}$
 - Positive opening contact
Contact separation:
 $2 \times \geq 1,5 \text{ mm}$
to VDE 0660 Teil 200
- Width
 - Single limit switch
11 mm
 - Double limit switch
15,5 mm
- All current carrying parts are gold-plated

STAHL

Because of the large number of actuator and circuit options which can be supplied, the scope for using the micro limit switches is very wide.

The devices can be supplied with silver contacts – or with gold-plated silver contacts for low currents and voltages.

The micro limit switches are designed for screw and clip-on mounting. Specially shaped fixing bushes enable several micro limit switches to be grouped together without expensive additional work.

Zone 1 and Zone 2

Single- and double-micro limit switch with snap-action contact, contact distance $2 \times \geq 0,3 \text{ mm}$

Version	Actuator	Reference	Actuator	Reference	Actuator	Reference	Actuator	Reference
8064 with flexible lead		M 1189K 000		M 1189K 101		M 1189K 102		M 1189K 103
		M 1189K 121		M 1189K 122		M 1189K 123		M 1189K 124
		M 1189K 241		M 1189K 242		M 1189K 243		M 1189K 244
8064 with single cores		M 1189K 245		M 1202K 246		M 1201K 247		M 1202K 248
		M 1203K 249		M 1204K 261		M 1204K 262		M 1205K 163
		M 1206K 164		M 1206K 266		M 1207K 173		

Ordering code: 8064/□1 - □□□ - □□ - □□□

Connection:

- Single cores
- Flexible lead

Contact material:

- Silver
- Silver, gold-plated galvanically

Switching arrangement:

10			Z. 1764
20			Z. 1770
30			Z. 1771
33	A		Z. 1778
38	B		Z. 1778
40			Z. 1767
44 ²⁾	A		Z. 1773
49 ²⁾	B		Z. 1773

Cable length:

- 0,5 m 05
- 1,0 m 10
- 3,0 m 30

Switching sequence:

- A Switching chambers 1 and 2 switch simultaneously
- B Switching chamber 2 switches after switching chamber 1

Switching chamber 2

Switching chamber 1

Note: Micro limit switches, contact distances $2 \times \geq 1,5 \text{ mm}$ on request

1) For same potential only
2) With single cores only

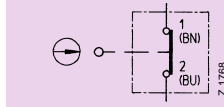
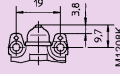
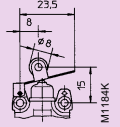
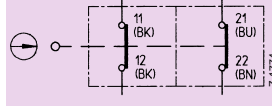
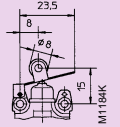
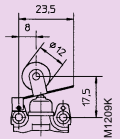

Micro limit switch with positive opening contact, contact distance $2 \times \geq 1,5$ mm

Version	Switching arrangements	Reference	Actuator	Reference
8064 with flexible lead 		50	 	000 261
		55	 	262 266
Ordering code: 8064/□5-□□□-□□□-□□□				
Connection: Single cores: 1 Flexible lead: 2		Contact material: Silver: 1 Silver, gold-plated galvanically: 3		Cable length: 0,5 m: 05 1,0 m: 10 3,0 m: 30



Dimensions, all dimensions in mm – subject to alteration

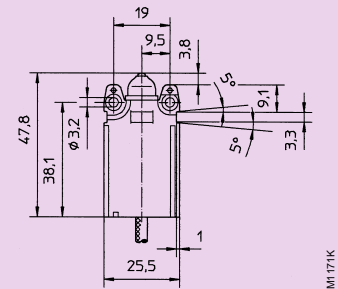

8064/25-...-000
Micro limit switch with flexible lead

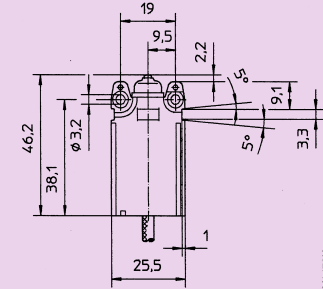

8064/21-...-000
Micro limit switch with flexible lead

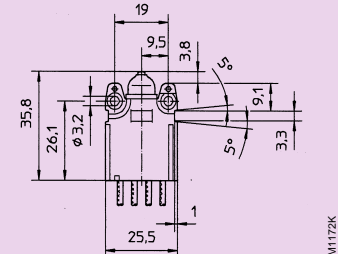

8064/15-...-000
Built-in micro limit switch with single cores

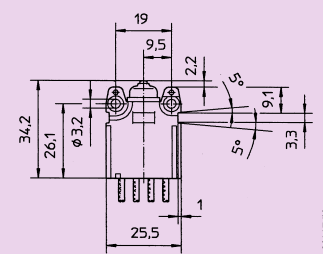

8064/11-...-000
Built-in micro limit switch with single cores

8064/.5, Micro limit switch with positive opening contacts, contact opening $2 \times \geq 1,5$ mm

8064/.1, Single micro limit switch with, snap-action contact, contact distance $\geq 0,6$ mm



Single micro limit switch



Double micro limit switch

For dimensions of drive heads, see selection tables.

Technical data						
Limit switch version	with snap-action contact		with positive opening contact			
Contact distance	2 × ≥ 0,3 mm		2 × ≥ 1,5 mm			
Explosive protection	EEx d IIC					
Built-in micro limit switch with single cores	EEx d IIC T6					
Micro limit switch with flexible lead	EEx d IIC T6					
Test certificate	PTB Nr. Ex-93.C.1014 U ¹⁾					
Built-in micro limit switch with flexible lead	¹⁾ The built-in micro limit switches are “incomplete electrical equipment“. They have to be installed in EEx e increased safety enclosures. Installation of the switch has to be checked by an authorized expert					
Micro-limit switch with flexible lead	PTB Nr. Ex-93.C.1015 X ²⁾ ²⁾ Micro limit switches with integral flexible lead must be installed with mechanical protection.					
Degree of protection	IP 66 (to IEC 529)					
Class of protection	II					
Ambient temperature	– 20° C ... + 40° C (+ 70° C on request)					
Materials	Thermoplastic					
Enclosure	Stainless steel					
Plunger	Stainless steel					
Additional actuator	Stainless steel					
Contact material	Silver or gold-plated silver					
Weight	Cable length	with single cores		with flexible lead		
Single limit switch	0,5 m	0,035 kg		0,060 kg		
	1,0 m	0,065 kg		0,100 kg		
	3,0 m	0,170 kg		0,200 kg		
Double limit switch	0,5 m	0,070 kg		0,080 kg		
	1,0 m	0,120 kg		0,150 kg		
	3,0 m	0,340 kg		0,415 kg		
Electrical connection	H07G-K, 0,75 mm ²					
Single cores	H05VV-F, 0,75 mm ²					
Flexible lead						
Life	> 2 × 10 ⁵ operations					
mechanical	depend on load					
electrical						
Max. switching frequency	3000 switching cycles per hour			1000 switching cycles per hour		
Silver contacts (with protective gold-plating)						
Rated voltage	max. 400 V, AC; max. 250 V, DC					
Rated current	acc. to DIN VDE 0630 2 A / 400 V, AC 7 A / 250 V, AC 0,5 A / 250 V, DC					
Breaking capacity	AC-11: 2,5 A / 400 V					
acc. to DIN VDE 0660 Teil 200	DC-11: 0,8 A / 250 V					
acc. to VDE 0630	Voltage AC	Ohmic loadt	Inductive load cos φ = 0,6	Voltage DC	Ohmic loadt	Inductive load L/R = 3 ms
	400 V	3 A	2 A	250 V	0,4 A	0,03 A
	250 V	5 A	3 A	30 V	7 A	5 A
	125 V	7 A	5 A			
	60 V	10 A	5 A			
	30 V	7 A	5 A			
Gold-plated contacts	on request					