

**TURBO srl**  
PULSE VALVES FOR DUST COLLECTOR FILTERS

**SERIES  
F  
THREADED**

**PART LIST AND MATERIALS**

PILOT GROUP FOR INTEGRAL PILOT OPERATED VALVES MODEL "FP"

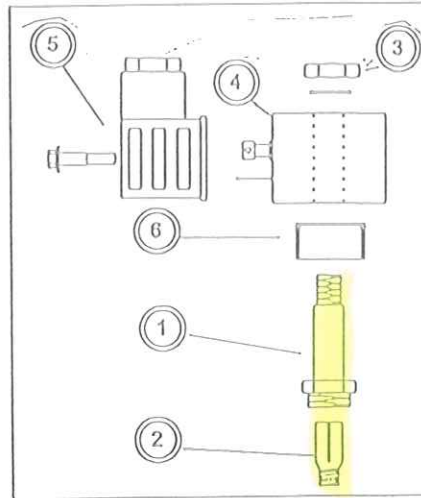

VALVE GROUP FOR REMOTE PILOT OPERATED, MODEL "FM"

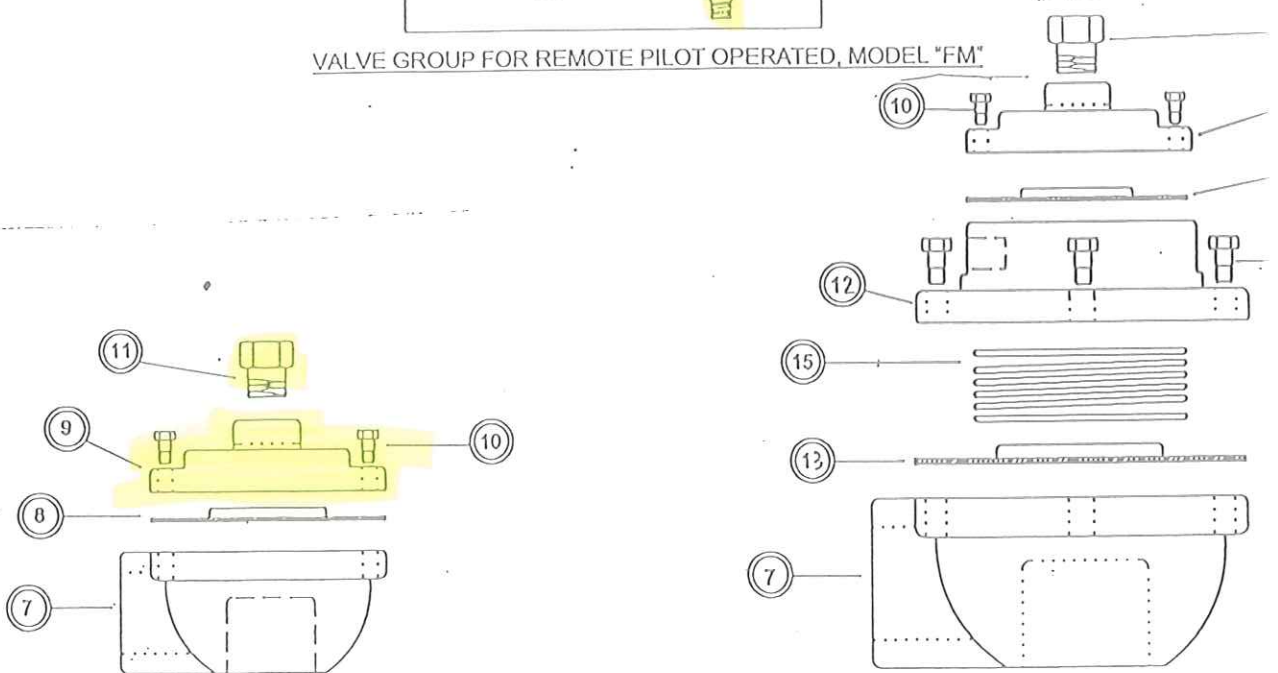

ITEM	DESCRIPTION	QTY	MATERIAL		CODE			GP10	GPC10*
			STD	OPTION	FP20	FP25	FP40		
1	CORE TUBE	1	BRASS	SST	TP10	TP10	TP10		
2	PLUNGER	1	SST	-	NGP	NGP	NGP		
3	NUT	1	SST	-	M10	M10	M10		
4	COIL	1	PBT	-	BH10*	BH10*	BH10*		
5	CONNECTOR	1	POLYAMID	-	PG9	PG9	PG9		
6	SILENCER	1	-	POLYAMID	SS	SS	SS		

\* ADD DESIRED POWER SUPPLY

ITEM	DESCRIPTION	QTY	MATERIAL		CODE					
			STD	OPTION	FP20	FP25	FP40	FM20	FM25	FM40
7	BODY	1	ALUMINIUM	-	B20	B25	B40	B20	B25	B40
8	DIAPHRAGM	1	NEOPRENE	VITON	M25	M25	M25	M25	M25	M25
9	MAIN COVER	1	ALUMINIUM	-	C20	C25	C40	CFM20	CFM25	CFM40
10	SCREWS	4	SST	-	M6x18	M6x18	M6x18	M6x18	M6x18	M6x18
11	ADAPTER	1	BRASS	-	-	-	-	RD18	RD18	RD18
12	MIDDLE COVER	1	ALUMINIUM	-	-	-	CM40	-	-	CM40
13	MAIN DIAPHRAGM	1	NEOPRENE	VITON	-	-	M40	-	-	M40
14	SCREWS	6	SST	-	-	-	M8x20	-	-	M8x20