

ELETTROPOMPE SACEMI AD IMMERSIONE SERIE SPV

SACEMI IMMERSION PUMPS SPV SERIES



CARATTERISTICHE

IMPIEGHI

Sono adatte al trasferimento di liquidi contenenti impurità

Vengono comunemente impiegate su:

Serie SPV 12 - SPV 33

- Macchine utensili (fresatrici, torni, trapani)
- Macchine per la lavorazione del vetro (versione TRI)
- Macchine da stampa
- Impianti di climatizzazione e condizionamento **SPV 25-33**
- Impianti di filtrazione **SPV 25-33**

Serie SPV 50 - SPV 150

- Macchine utensili (fresatrici, torni)
- Macchine per la lavorazione del vetro (versione TRI ove possibile)
- Macchine da stampa
- Cabina di verniciatura **SPV 50-75**
- Impianti di climatizzazione e condizionamento **SPV 100-150**

Motore

2 poli - 2800 giri - trifase

Classe F IP55

CHARACTERISTICS

Uses

Suitable for transferring liquids containing impurities

Commonly used on:

Series SPV 12 - SPV 33

- Machine tools (milling units, lathes, drills)
- Glass-working machines (TRI version)
- Printing machines
- Air conditioning systems **SPV 25-33**
- Filtering systems **SPV 25-33**

Series SPV 50 - SPV 150

- Machine tools (milling units, lathes)
- Glass-working machines (TRI version where possible)
- Printing machines
- Painting booths **SPV 50-75**
- Air-conditioning systems **SPV 100-150**

Motor

2 poles - 2800 rpm - three-phase

Class F IP55

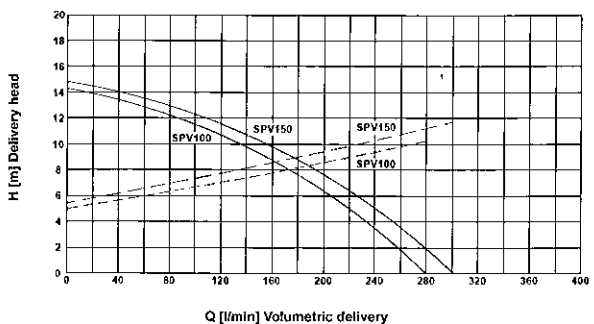
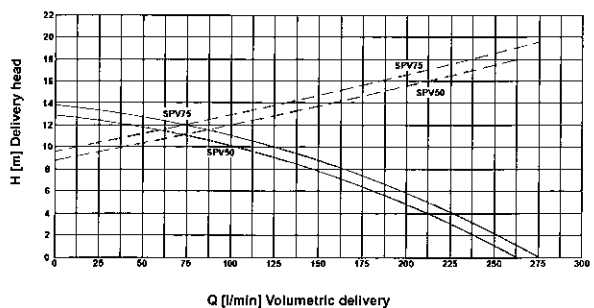
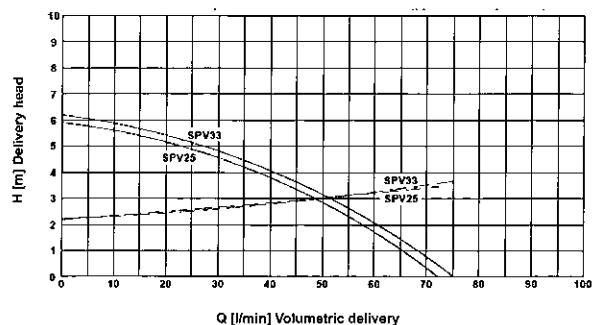
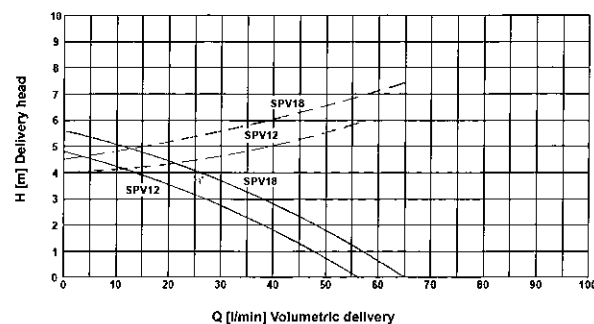

I dati riportati in questo diagramma sono riferiti ad una viscosità non superiore a 5 CST a 20°C.
The details shown on this diagram refer to a viscosity of not more than 5 CST at 20°C.

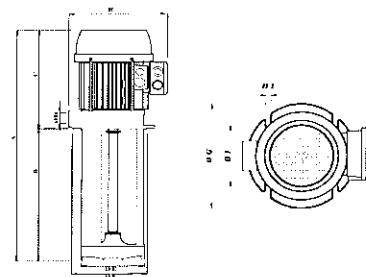

Tipo/Type **SPV 12 + SPV 33**

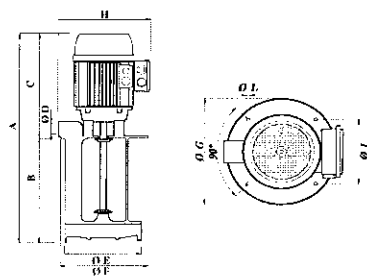

Tipo/Type **SPV 50 + SPV 150**

Articolo Art.	Tipo Type	Kw	A mm.	B mm.	C mm.	Ø D Gas	Ø E mm.	Ø F mm.	Ø G mm.	H mm.	Ø I mm.	Ø L mm.	Temp. Liquido Max Max Liquid Temp.
MU.70			255	90									
MU.71			285	120									
MU.72	SPV.12	0.15	335	170	165	3/4"	98	100	130	151	115	7	70°C
MU.73			385	220									
MU.74			435	270									
MU.75			515	350									
MU.80			255	90									
MU.81			285	120									
MU.82	SPV.18	0.17	335	170	165	3/4"	98	100	130	151	115	7	70°C
MU.83			385	220									
MU.84			435	270									
MU.85			515	350									
MU.90			300	90									
MU.91			330	120									
MU.92	SPV.25	0.26	380	170	210	3/4"	98	100	130	170	115	7	70°C
MU.93			430	220									
MU.94			480	270									
MU.95			560	350									
MU.100			300	90									
MU.101			330	120									
MU.102	SPV.33	0.36	380	170	210	3/4"	98	100	130	170	115	7	70°C
MU.103			430	220									
MU.104			480	270									
MU.105			560	350									
MU.501			460	200									
MU.502	SPV.50	1.00	530	270	260	1-1/4"	138	140	180	215	160	7	70°C
MU.503			610	350									
MU.506			460	200									
MU.507	SPV.75	1.20	530	270	260	1-1/4"	138	140	180	215	160	7	70°C
MU.508			610	350									
MU.511			500	200									
MU.512	SPV.100	1.01	570	270	300	1-1/4"	138	140	180	230	160	9	70°C
MU.513			650	350									
MU.516			500	200									
MU.517	SPV.150	1.41	570	270	300	1-1/4"	138	140	180	230	160	9	70°C
MU.518			650	350									

N.B. Per il corretto utilizzo delle pompe si consiglia la visione della **tabella impieghi** illustrata a pagina 108.
NOTE: For correct pump use, see uses table on page 108.

